



Smart Bluetooth Finder



User Guide

APP Installation

SiGN Smart Home App can be found on both Google Play and App store to download freely.

Pairing

Before you pairing your SiGN smart finder check that you activated bluetooth on your phone. Open the SiGN app and click on "Add device" afterwards click "Automatic Scan" at the top of the menu.

Now place your SiGN smart finder near your phone and press SiGN logo on your smart finder.

Click next to start your pair pairing. When the icon is displayed it means that the pair connection is successful.

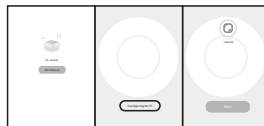

Ring Smart Finder

Click the bell icon in the app to ring smart finder which can be attached to your valuable items like keys, wallets, purses, luggage, cameras, bikes, tablets, backpacks, etc.



Ring Your Phone

Double-click the button on smart finder to ring your phone. This can help you find your phone in seconds, even if it's on silent mode

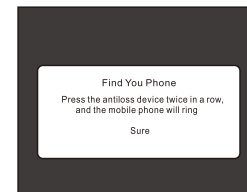

Lost Location

To use this feature, you must activate the GPS on your smartphone. If you lose your smart finder or the item equipped with it, the last lost location will be saved automatically.

You can see this place by entering in the app.

Setting

You can go to settings in the SiGN app and in to specifications to activate notifications. When you have activated notifications, both the phone and the bluetooth finder will emit a signal when they are far away from each other.

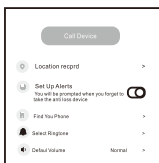

Battery Replacement

1. Open the cover by turning it.
2. Replace the CR2032 battery.
3. Close the cover again.



Specification

Dimensions:	L37mm x W37mm x H8.5mm
Bluetooth Version:	Bluetooth 4.0
Range:	0-50meters(in open space)
Buzzer:	90-95dB
Indicator:	Blue LED
Battery:	CR2032 battery

Compatible Smartphones

ios (ios 8.0 or higher)	iPhone: 4S/5/5S/6/6plus//SE//Plus iPhone XR/iPhone SE/iPhone XS iPad: 3th Generation/Geni/Mini or later iPad Mini or later iPod Touch 5 or later
Android (Android 4.4 or higher)	Samsung Galaxy S4/S5/S6/S7 Galaxy Note: 3/4/5/6/Galaxy C5/C7/C9 Galaxy A5/A7/A9/Nexus 4/5/5X/6/6P Xiaomi A2, one Plus 7/Meizu 16x/Vivo Y81s/ OPPO R8/Honor TX

Note:

If your smartphone is not on this list but also uses Android 4.4 and Bluetooth 4.0, there is a good chance the smart finder will work fine, but we are not able to offer the same level of support in troubleshooting scenarios.