



SIGN

## BLUETOOTH FLIGHT ADAPTER MANUAL



MODEL: SN-BTFLY

### Product design:

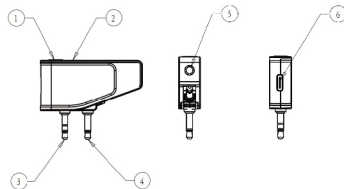

1. ON/OFF (Press 2 seconds for ON - Press 3 seconds for OFF)
2. LED indicator
3. Rear audio input
4. Single audio input
5. Rear audio output
6. USB Type-C charging output

Attention! Wireless earphones and earphones with cable can be connected at the same time to the adapter.

1

### Flight adapter:

1. Connect the two 3.5mm audio inputs to the airline outputs.
2. Turn on your wireless earphones and make sure they're not linked or connected to any other device.

Attention! ON/OFF button on your wireless headphones is either found on the earphones or on the charging case. With Apple AirPods you need to keep the button pressed down.



3. Turn on the adapter until blue LED light starts to blink. Keep earphones close to it and watch as the light starts to blink slower. The adapter will search for the strongest signal earphones and pair automatically. When successfully paired with earphones, the blue LED light will stop blinking.
4. If using earphones with cable, simply connect the 3.5mm input to the 3.5mm output on the adapter. When connected it will automatically work.

2

### Bluetooth transmitter:

1. Connect the one 3.5mm audio input of adapter to audio output on computer, television, MP3 player or other device with audio output.
2. Turn on your wireless earphones and make sure they're not linked or connected to any other device.

Attention! ON/OFF button on your wireless headphones is either found on the earphones or on the charging case. With Apple AirPods you need to keep the button pressed down.

3. Turn on the adapter until blue LED light starts to blink. Keep earphones close to it and watch as the light starts to blink slower. The adapter will search for the strongest signal earphones and pair automatically. When successfully paired with earphones, the blue LED light will stop blinking.



4. If using earphones with cable, simply connect the 3.5mm input to the 3.5mm output on the adapter. When connected it will automatically work.

3

### Low battery:

When battery is low on the adapter a blinking light will show as an indicator for low power status, Before it shuts off the blue LED light will blink 3 times and then power off.

### Charging:

Charge the adapter with a USB Type-C cable. When charging the adapter a red LED light will show and it will turn off when the adapter is fully charged.



### Product specifications:

- **Model:** SN-BTFLY
- **Distance:** Approx. 8m (in barrier-free environment)
- **Bluetooth version:** 5.0
- **Charging time:** About 2h
- **Battery capacity:** 200mAh 3.7V
- **Battery type:** Lithium Polymer
- **Supports:** HSP/HFP/A2DP

Attention! All technical information is based on actual performance.

4

### Additional info:

1. Read this manual carefully before use.
2. Charge the adapter before use.
3. If you haven't used the adapter for over one month, be sure to charge it first.
4. Use charger that has passed 3C certificate.
5. Make sure your Bluetooth device is free and available to be "matched".
6. When blue LED light shows it means that the adapter is already matched to a device. If it's not your device connected, restart the adapter and put your earphones closer to attempt connecting again.

### Warning:

1. Do not open or attempt to repair the adapter as it may destroy it.
2. Do not keep the adapter in environments below 0°C or higher than 45°C.
3. Be careful with LED indicator around children's or animal's eyes.
4. Do not use adapter during thunderstorm, it may cause electric shocks.
5. Do not clean the adapter with oil or other volatile liquids.
6. Do not wet the adapter with liquids.

Spares Nordic AB  
Fagerstagatan 7  
163 53 Spånga, Sweden



Made in China

5