

SiGN Smart Home Kamera 360°



SWE Användarmanual
SNSM-SECCAM720P

SPECIFIKATIONER

Upplösning: 3MP
WiFi: 2,4 GHz
Mörkerseende: Ja
Röststyrning: Ja
Mikrofon/Högtalare: Ja
MicroSD kortplats: Ja, max 64gb
Märke: Sign
Input: 5V 1A(min)
Total strömförbrukning: 5W (max)
Stödjer: Android/iOS
Bildförbättring: Digital Wide Dynamic 3d + brusreducering
Videokomprimering: H.264 Hög profil

01

FÖRPACKNINGSSINNEHÅLL

- Smart kamera x 1
- Användarmanual x 2
- USB nätsladd x 1
- Strömadapter x 1
- Skruvset x 1

NOTERA

Återställningsknapp: Tryck i 5 sek på RESET knapp för att återställa.

Det rekommenderas att sätta i 1-128gb Micro kort, annars kommer det inte att kunna lagra, se videohistorik och stödja viktiga funktioner som uppgradering.

02

SÄKERHETSINFORMATION

- Undvik att röra metallytan.
- Undvik att blockera enheten.
- Kontrollera att enheten får god WiFi signal.
- Vid byte av nätverk: Återställ kameran
- Ta ej itu produkten.
- Ha enheten på en lämplig plats

INSTALLERA

1. Ladda ner SiGN Smart Home app från App Store eller Google Play. Skanna QR koden.

Registrera dig och logga in.

Notera att SiGN Smart Home appen behöver 2.4GHz WiFi för att användas.



SiGN Smart Home

03

2. Öppna appen och tryck på ikonen "+" för att lägga till enheten. Välj produkten du vill använda.

3. Anslut enheten till ström. Ljuset på lampan ska blinka. Om inte ljuset blinkar - återställ enheten genom att slå strömmen av/på.

4. Anslut till ditt WiFi nätverk, och fullfölj instruktionerna därefter.

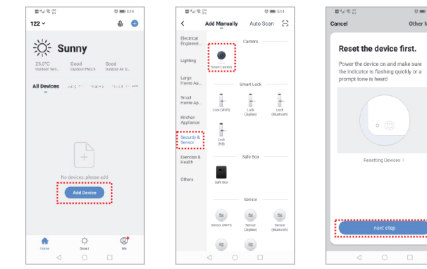

04

5. Använd kameran för att scanna QR koden som kommer fram på din mobilskärm. Håll din kamera cirka 20-30 cm från din mobil. Vänta på bekräftad koppling.

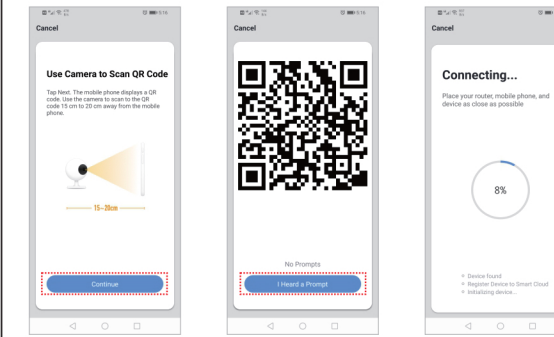

05

Namn och innehåll av de skadliga ämnena i produkten

Del	Skadliga ämnen					
	Pb	Hg	Cd	Cr(VI)	PBB	PBDE
Skal	○	○	○	○	○	○
Bräda	X	○	○	○	○	○
Laddare	○	○	○	○	○	○
Annex	○	○	○	○	○	○

This form is based on the provisions of SJ/T 11364.

Denna produkt uppfyller Rohs miljöskydds krav.

06

SiGN Smart Home 3MP Camera with 360°



Thank you for using smart camera
SNSM-SECCAM720P

1. Install APP

Download "SiGN Smart Home" app from APP store or Google Play. Register and login: open the "SiGN Smart Home" APP to register and login according to the prompts.

2. Product Introduction

Packing list: Smart Camera x 1, Manual x 2, USB Power Cord x 1, Power Adapter x 1, Screw Accessories Package x 1



Smart Camera

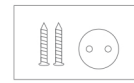

Screw Accessories Package

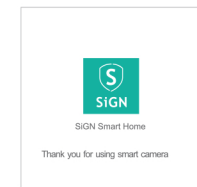

Manual



USB Power Cord

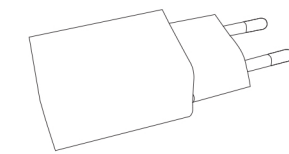

Power Adapter

Basic Parameters

Product Name: Smart Camera
Pixel: 3MP
Video Compression: H.264 High Profile
Image Enhancement: Digital Wide Dynamic 3D Noise Reduction
Local Storage: MicroTF card
Wireless Encryption: WEP/WPA/WPA2 Encryption
Power Input: 5V 1A(Min)
Total Power Consumption: 5W (Max)
Wifi Frequency: 2.4G 802.11 b/g/n
Support Platform: Android/iOS

Component Description:

Reset Button: Long press "reset" hole 5sec, reset success.

It is recommended to insert 1-128 GB high-speed Micro TF card, otherwise it will not be able to store, view historical video and support important functions such as firmware upgrading.

Add The Device-Scan QR code mode

- Make sure Wi-Fi is available and connected to the Internet.
- Connect the camera to the power, then system startup completed.
- Open "Smart Life" APP, press the "+" in the upper right corner of the main screen (Figure 01); choose "Security & Video Surveillance", click "Smart Camera" (Figure 02) to add camera; and then click "Next step" (Figure 03).

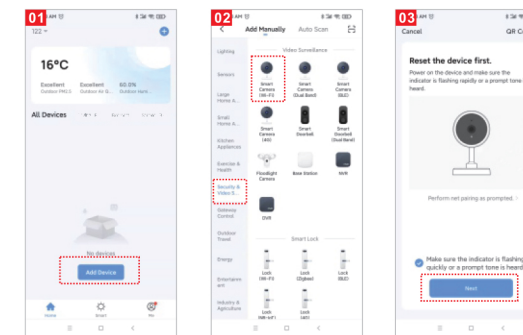

Please note that only 2.4 GHz Wi-Fi network is supported;

- If the mobile phone is not connected to wi-fi, please click "Connect to Wi-Fi" (Figure 04);
- It will jump to the WLAN interface and connects Wi-Fi (Figure 05).
- If the phone is connected to Wi-Fi (Figure 06);

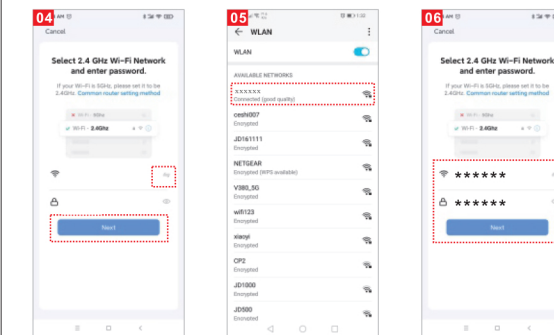

- A QR code will prompt on your screen and you need to scan it with the Smart Camera. (the camera is about 20-30 cm away from the mobile phone lens). Then click "hear the prompt sound" (Figure. 07).
- "connecting" (Figure. 08);

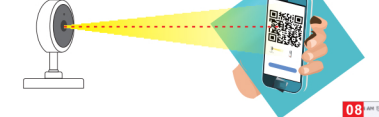

SiGN Smart Home

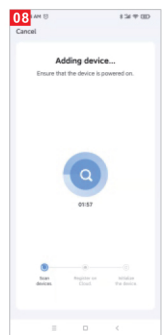

Adding device...

- connection completed(Figure 09), and click "Done";
- Then jump to preview interface (Figure 10)
- After closing the device preview interface, the interface returns to the APP home page. At this time, the connected device will appear on the APP home page (Figure 11). Then you can click directly to the device interface to see the monitoring situation without re-adding afterwards.

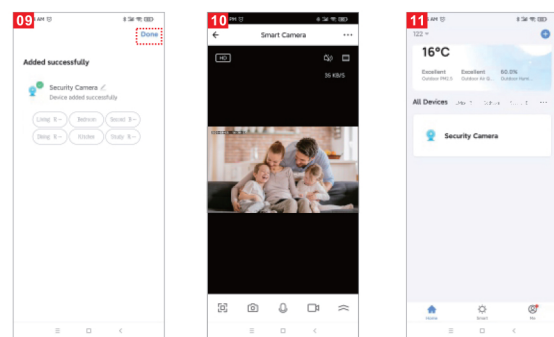

- Click to complete the connection (Figure 18)
- Video screen (Picture 19)

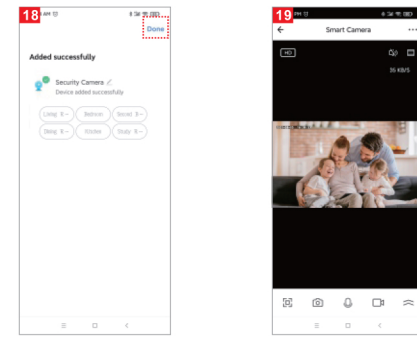

5. Matters Need Attention

Try to keep away from the metal space:
Avoid the furniture, microwave oven blocked;
Avoid the space where the audio, video and data lines are wound, and keep the space away from them as large as possible;
Ensure that as close as possible to the coverage of wireless Wi-Fi signals. Switching network environment;
In the new network environment, please press the reset hole about 5 seconds, then connect to the network.

The name and content of the harmful substances in the product

Part Name	Harmful Substance					
	Pb	Hg	Cd	Cr(VI)	PBB	PBDE
shell	○	○	○	○	○	○
Board	X	○	○	○	○	○
charger	○	○	○	○	○	○
annex	○	○	○	○	○	○

This form is based on the provisions of SJ/T 11364.

This product conforms to RoHS environmental protection requirements. At present, there is no mature technology in the world to replace or reduce the lead content in the electronic ceramics, porcelain, optical glass, steel and copper alloy.

Spares Nordic AB
Järnyxgatan 17
213 75, Malmö Sweden
CE RoHS
Made in China